



STATE OF NORTH CAROLINA  
DEPARTMENT OF TRANSPORTATION

JOSH STEIN  
GOVERNOR

DANIEL H. JOHNSON  
SECRETARY

June 9, 2026

**Addendum No. 1**

RE: Contract # C205186

WBS # BP7.R001.3

STATE FUNDED

**Rockingham County**

BRIDGE #780023 OVER US-29 ON US-29 BUSINESS.

**June 16, 2026 Letting**

To Whom It May Concern:

Reference is made to the plans and proposal furnished to you on this project.

The following revisions have been made to the Structures plans.

Sheet No.	Revision
S-4	Concrete Medallion Panel pay item added to Bill of Materials.
S-33	Notes updated to include Medallion Panels.
S-34A (New)	New Plan Sheet added with details of Concrete Medallion Panel.

Please void the above listed sheets in your plans and staple the revised sheets thereto.

The following revisions have been made to the proposal.

Page No.	Revision
Proposal Cover	Note added that reads "Includes Addendum No. 1 Dated 06-09-2026".
Proposal Page	Engineer of Record seal and title updated.
ST-25 (New)	The Unit Project Special Provision entitled <b>CONCRETE MEDALLION PANEL</b> has been added.

Please void the above listed pages in your proposal and staple the revised pages thereto.

On the item sheets the following pay item revision has been made:

<u>Item</u>	<u>Description</u>	<u>Old Quantity</u>	<u>New Quantity</u>
0189- 8897000000-N SP	CONCRETE MEDALLION PANEL	NEW	2 EACH

The Contractor's bid must include these pay item revisions.

The electronic bidding file has been updated to reflect these revisions. Please download the Addendum File and follow the instructions for applying the addendum. Bid Express will not accept your bid unless the addendum has been applied.

The contract will be prepared accordingly.

Sincerely,

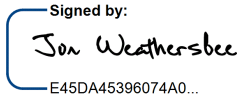
Signed by:  
  
E45DA45396074A0...

Jon Weathersbee, PE  
State Contract Officer

JHW/jcm  
Attachments

cc: Mr. Wiley W. Jones III, PE  
Wright R. Archer, III, PE  
Mr. Ken Kennedy, PE  
Mr. Malcolm Bell  
Mr. Forrest Dungan, PE  
Ms. Jaci Kincaid  
Mr. Jon Weathersbee, PE  
Project File (2)

STATE OF NORTH CAROLINA  
DEPARTMENT OF TRANSPORTATION  
RALEIGH, N.C.

PROPOSAL

**INCLUDES ADDENDUM No. 1 DATED 06-09-2026**

DATE AND TIME OF BID OPENING: **Jun 16, 2026 AT 02:00 PM**

CONTRACT ID C205186  
WBS BP7.R001.3

FEDERAL-AID NO. STATE FUNDED  
COUNTY ROCKINGHAM  
T.I.P NO. BP7-R001  
MILES 0.356  
ROUTE NO. US-29  
LOCATION BRIDGE #780023 OVER US-29 ON US-29 BUSINESS.

TYPE OF WORK GRADING, DRAINAGE, PAVING, SIGNALS, AND STRUCTURES.

**NOTICE:**

ALL BIDDERS SHALL COMPLY WITH ALL APPLICABLE LAWS REGULATING THE PRACTICE OF GENERAL CONTRACTING AS CONTAINED IN CHAPTER 87 OF THE GENERAL STATUTES OF NORTH CAROLINA WHICH REQUIRES THE BIDDER TO BE LICENSED BY THE N.C. LICENSING BOARD FOR CONTRACTORS WHEN BIDDING ON ANY NON-FEDERAL AID PROJECT WHERE THE BID IS \$40,000 OR MORE, EXCEPT FOR CERTAIN SPECIALTY WORK AS DETERMINED BY THE LICENSING BOARD. BIDDERS SHALL ALSO COMPLY WITH ALL OTHER APPLICABLE LAWS REGULATING THE PRACTICES OF ELECTRICAL, PLUMBING, HEATING AND AIR CONDITIONING AND REFRIGERATION CONTRACTING AS CONTAINED IN CHAPTER 87 OF THE GENERAL STATUTES OF NORTH CAROLINA. NOTWITHSTANDING THESE LIMITATIONS ON BIDDING, THE BIDDER WHO IS AWARDED ANY FEDERAL - AID FUNDED PROJECT SHALL COMPLY WITH CHAPTER 87 OF THE GENERAL STATUTES OF NORTH CAROLINA FOR LICENSING REQUIREMENTS WITHIN 60 CALENDAR DAYS OF BID OPENING.

**BIDS WILL BE RECEIVED AS SHOWN BELOW:**

**THIS IS A ROADWAY & STRUCTURE PROPOSAL**

**5% BID BOND OR BID DEPOSIT REQUIRED**

---

**PROPOSAL FOR THE CONSTRUCTION OF  
CONTRACT No. C205186 IN ROCKINGHAM COUNTY, NORTH CAROLINA  
DEPARTMENT OF TRANSPORTATION,  
RALEIGH, NORTH CAROLINA**

The Bidder has carefully examined the location of the proposed work to be known as Contract No. **C205186** has carefully examined the plans and specifications, which are acknowledged to be part of the proposal, the special provisions, the proposal, the form of contract, and the forms of contract payment bond and contract performance bond; and thoroughly understands the stipulations, requirements and provisions. The undersigned bidder agrees to bound upon his execution of the bid and subsequent award to him by the Board of Transportation in accordance with this proposal to provide the necessary contract payment bond and contract performance bond within fourteen days after the written notice of award is received by him. The undersigned Bidder further agrees to provide all necessary machinery, tools, labor, and other means of construction; and to do all the work and to furnish all materials, except as otherwise noted, necessary to perform and complete the said contract in accordance with the *2024 Standard Specifications for Roads and Structures* by the dates(s) specified in the Project Special Provisions and in accordance with the requirements of the Engineer, and at the unit or lump sum prices, as the case may be, for the various items given on the sheets contained herein.

The Bidder shall provide and furnish all the materials, machinery, implements, appliances and tools, and perform the work and required labor to construct and complete Contract No. **C205186** in **Rockingham County**, for the unit or lump sum prices, as the case may be, bid by the Bidder in his bid and according to the proposal, plans, and specifications prepared by said Department, which proposal, plans, and specifications show the details covering this project, and hereby become a part of this contract.

The published volume entitled *North Carolina Department of Transportation, Raleigh, Standard Specifications for Roads and Structures, January 2024* with all amendments and supplements thereto, is by reference incorporated into and made a part of this contract; that, except as herein modified, all the construction and work included in this contract is to be done in accordance with the specifications contained in said volume, and amendments and supplements thereto, under the direction of the Engineer.

If the proposal is accepted and the award is made, the contract is valid only when signed either by the Contract Officer or such other person as may be designated by the Secretary to sign for the Department of Transportation. The conditions and provisions herein cannot be changed except over the signature of the said Contract Officer.

The quantities shown in the itemized proposal for the project are considered to be approximate only and are given as the basis for comparison of bids. The Department of Transportation may increase or decrease the quantity of any item or portion of the work as may be deemed necessary or expedient.

An increase or decrease in the quantity of an item will not be regarded as sufficient ground for an increase or decrease in the unit prices, nor in the time allowed for the completion of the work, except as provided for the contract.

Accompanying this bid is a bid bond secured by a corporate surety, or certified check payable to the order of the Department of Transportation, for five percent of the total bid price, which deposit is to be forfeited as liquidated damages in case this bid is accepted and the Bidder shall fail to provide the required payment and performance bonds with the Department of Transportation, under the condition of this proposal, within 14 calendar days after the written notice of award is received by him, as provided in the *Standard Specifications*; otherwise said deposit will be returned to the Bidder.



*State Contract Officer*

Signed by:

*Jonathan H. Weathersbee*

E45DA45396074A0...

06/09/2026

# ST-25

Project BP7.R001

Rockingham County

## **CONCRETE MEDALLION PANEL (SPECIAL)**

The work covered by this special provision shall consist of constructing and installing concrete medallion panels as indicated on the Plans and in this Special Provision. The contractor shall furnish all materials, labor, equipment, and incidentals necessary for the construction and installation of concrete medallion panels.

Concrete medallion panels shall be constructed in accordance with Section 1077 of the Standard Specifications and this Provision. Concrete medallion panels shall be Class "A" concrete using pea gravel as specified on the plans.

Payment for work performed on the concrete medallion panels as detailed in the Plans and this Special Provision will be paid for as "Concrete Medallion Panels". Payment will include the fabrication of medallion panels, coloring stains, the construction, finishing, and removal of all equipment, materials, labor and incidentals necessary to complete the work in the conformance with the Contract Documents.

**Pay Item**

Concrete Medallion Panel

**Pay Unit**

Each

County: ROCKINGHAM

Line #	Item Number	Sec #	Description	Quantity	Unit Cost	Amount
<b>ROADWAY ITEMS</b>						
0001	0000100000-N	800	MOBILIZATION	Lump Sum	L.S.	
0002	0000400000-N	801	CONSTRUCTION SURVEYING	Lump Sum	L.S.	
0003	0001000000-E	200	CLEARING & GRUBBING .. ACRE(S)	Lump Sum	L.S.	
0004	0008000000-E	200	SUPPLEMENTARY CLEARING & GRUBBING	1 ACR		
0005	0022000000-E	225	UNCLASSIFIED EXCAVATION	7,500 CY		
0006	0036000000-E	225	UNDERCUT EXCAVATION	450 CY		
0007	0106000000-E	230	BORROW EXCAVATION	34,700 CY		
0008	0134000000-E	240	DRAINAGE DITCH EXCAVATION	595 CY		
0009	0156000000-E	250	REMOVAL OF EXISTING ASPHALT PAVEMENT	12,255 SY		
0010	0163000000-E	250	REMOVAL OF EXISTING CONCRETE PAVEMENT	12,280 SY		
0011	0195000000-E	265	SELECT GRANULAR MATERIAL	400 CY		
0012	0196000000-E	270	GEOTEXTILE FOR SOIL STABILIZATION	400 SY		
0013	0199000000-E	SP	TEMPORARY SHORING	1,094 SF		
0014	0248000000-N	SP	GENERIC GRADING ITEM TYPE 2 BRIDGE APPROACH FILL, STATION 22+03.27 -L-	Lump Sum	L.S.	
0015	0318000000-E	300	FOUNDATION CONDITIONING MATERIAL, MINOR STRUCTURES	210 TON		
0016	0321000000-E	300	FOUNDATION CONDITIONING GEOTEXTILE	655 SY		
0017	0335300000-E	305	18" DRAINAGE PIPE	156 LF		

County: ROCKINGHAM

Line #	Item Number	Sec #	Description	Quantity	Unit Cost	Amount
0018	0335600000-E	305	36" DRAINAGE PIPE	62 LF		
0019	0335850000-E	305	*** DRAINAGE PIPE ELBOWS (18")	4 EA		
0020	0372000000-E	310	18" RC PIPE CULVERTS, CLASS III	444 LF		
0021	0378000000-E	310	24" RC PIPE CULVERTS, CLASS III	312 LF		
0022	0384000000-E	310	30" RC PIPE CULVERTS, CLASS III	380 LF		
0023	0448300000-E	310	18" RC PIPE CULVERTS, CLASS IV	268 LF		
0024	0449000000-E	310	*** RC PIPE CULVERTS, CLASS V (18")	232 LF		
0025	0973100000-E	330	*** WELDED STEEL PIPE, ***** THICK, GRADE B IN SOIL (24", 0.250")	52 LF		
0026	0973100000-E	330	*** WELDED STEEL PIPE, ***** THICK, GRADE B IN SOIL (30", 0.375")	100 LF		
0027	0973100000-E	330	*** WELDED STEEL PIPE, ***** THICK, GRADE B IN SOIL (36", 0.500")	96 LF		
0028	0973300000-E	330	*** WELDED STEEL PIPE, ***** THICK, GRADE B NOT IN SOIL (24", 0.250")	52 LF		
0029	0973300000-E	330	*** WELDED STEEL PIPE, ***** THICK, GRADE B NOT IN SOIL (30", 0.375")	100 LF		
0030	0973300000-E	330	*** WELDED STEEL PIPE, ***** THICK, GRADE B NOT IN SOIL (36", 0.500")	96 LF		
0031	0995000000-E	340	PIPE REMOVAL	430 LF		
0032	0996000000-N	350	PIPE CLEAN OUT	2 EA		
0033	1011000000-N	500	FINE GRADING	Lump Sum	L.S.	

County: ROCKINGHAM

Line #	Item Number	Sec #	Description	Quantity	Unit Cost	Amount
0034	1099500000-E	505	SHALLOW UNDERCUT	100 CY		
0035	1099700000-E	505	CLASS IV SUBGRADE STABILIZATION	200 TON		
0036	1112000000-E	505	GEOTEXTILE FOR SUBGRADE STABILIZATION	300 SY		
0037	1121000000-E	520	AGGREGATE BASE COURSE	6,930 TON		
0038	1220000000-E	545	INCIDENTAL STONE BASE	159 TON		
0039	1275000000-E	600	PRIME COAT	3,300 GAL		
0040	1330000000-E	607	INCIDENTAL MILLING	140 SY		
0041	1491000000-E	610	ASPHALT CONC BASE COURSE, TYPE B25.0C	3,040 TON		
0042	1503000000-E	610	ASPHALT CONC INTERMEDIATE COURSE, TYPE I19.0C	4,430 TON		
0043	1523000000-E	610	ASPHALT CONC SURFACE COURSE, TYPE S9.5C	4,900 TON		
0044	1575000000-E	620	ASPHALT BINDER FOR PLANT MIX	640 TON		
0045	1577000000-E	620	POLYMER MODIFIED ASPHALT BINDER FOR PLANT MIX	20 TON		
0046	1839140000-E	661	ULTRA-THIN BONDED WEARING COURSE	340 TON		
0047	1841000000-E	665	GENERIC PAVING ITEM MILLED RUMBLE STRIPS (ASPHALT CONCRETE), (16")	4,800 LF		
0048	1891000000-E	SP	GENERIC PAVING ITEM FINE MILLING	9,960 SY		
0049	2020000000-N	806	CONTROL-OF-ACCESS MARKERS	4 EA		
0050	2022000000-E	815	SUBDRAIN EXCAVATION	44.8 CY		

County: ROCKINGHAM

Line #	Item Number	Sec #	Description	Quantity	Unit Cost	Amount
0051	2026000000-E	815	GEOTEXTILE FOR SUBSURFACE DRAINS	200 SY		
0052	2036000000-E	815	SUBDRAIN COARSE AGGREGATE	33.6 CY		
0053	2044000000-E	815	6" PERFORATED SUBDRAIN PIPE	200 LF		
0054	2070000000-N	815	SUBDRAIN PIPE OUTLET	1 EA		
0055	2077000000-E	815	6" OUTLET PIPE	6 LF		
0056	2099000000-E	816	SHOULDER DRAIN	1,280 LF		
0057	2110000000-E	816	4" SHOULDER DRAIN PIPE	1,280 LF		
0058	2121000000-E	816	4" OUTLET PIPE FOR SHOULDER DRAINS	15 LF		
0059	2132000000-N	816	CONCRETE PAD FOR SHOULDER DRAIN PIPE OUTLET	1 EA		
0060	2209000000-E	838	ENDWALLS	4 CY		
0061	2275000000-E	SP	FLOWABLE FILL	45 CY		
0062	2286000000-N	840	MASONRY DRAINAGE STRUCTURES	29 EA		
0063	2308000000-E	840	MASONRY DRAINAGE STRUCTURES	25 LF		
0064	2364200000-N	840	FRAME WITH TWO GRATES, STD 840.20	21 EA		
0065	2365000000-N	840	FRAME WITH TWO GRATES, STD 840.22	2 EA		
0066	2374000000-N	840	FRAME WITH GRATE & HOOD, STD 840.03, TYPE ** (F)	5 EA		
0067	2396000000-N	840	FRAME WITH COVER, STD 840.54	1 EA		

County: ROCKINGHAM

Line #	Item Number	Sec #	Description	Quantity	Unit Cost	Amount
0068	2451000000-N	852	CONCRETE TRANSITIONAL SECTION FOR DROP INLET	5 EA		
0069	2549000000-E	846	2'-6" CONCRETE CURB & GUTTER	400 LF		
0070	2556000000-E	846	SHOULDER BERM GUTTER	600 LF		
0071	2619000000-E	850	4" CONCRETE PAVED DITCH	70 SY		
0072	2655000000-E	852	5" MONOLITHIC CONCRETE ISLANDS (KEYED IN)	1,015 SY		
0073	2717200000-E	854	MEDIAN HAZARD PROTECTION	85 LF		
0074	2724000000-E	857	PRECAST REINFORCED CONCRETE BARRIER, SINGLE FACED	395 LF		
0075	3001000000-N	SP	IMPACT ATTENUATOR UNITS, TYPE TL-3	2 EA		
0076	3030000000-E	862	STEEL BEAM GUARDRAIL	1,562.5 LF		
0077	3045000000-E	862	STEEL BEAM GUARDRAIL, SHOP CURVED	250 LF		
0078	3145000000-E	862	EXTRA LENGTH GUARDRAIL POST (***) (8')	52 EA		
0079	3150000000-N	862	ADDITIONAL GUARDRAIL POSTS	10 EA		
0080	3195000000-N	862	GUARDRAIL END UNITS, TYPE AT-1	1 EA		
0081	3210000000-N	862	GUARDRAIL END UNITS, TYPE CAT-1	2 EA		
0082	3215000000-N	862	GUARDRAIL ANCHOR UNITS, TYPE III	2 EA		
0083	3287000000-N	862	GUARDRAIL END UNITS, TYPE TL-3	4 EA		
0084	3317000000-N	862	GUARDRAIL ANCHOR UNITS, TYPE B-77	11 EA		

County: ROCKINGHAM

Line #	Item Number	Sec #	Description	Quantity	Unit Cost	Amount
0085	3360000000-E	863	REMOVE EXISTING GUARDRAIL	2,500 LF		
0086	3365000000-E	863	REMOVE EXISTING GUIDERAIL	90 LF		
0087	3389400000-E	865	DOUBLE FACED CABLE GUIDERAIL	230 LF		
0088	3389500000-N	865	ADDITIONAL GUIDERAIL POSTS	5 EA		
0089	3389600000-N	865	CABLE GUIDERAIL ANCHOR UNITS	3 EA		
0090	3503000000-E	866	WOVEN WIRE FENCE, 47" FABRIC	115 LF		
0091	3509000000-E	866	4" TIMBER FENCE POSTS, 7'-6" LONG	5 EA		
0092	3515000000-E	866	5" TIMBER FENCE POSTS, 8'-0" LONG	10 EA		
0093	3566000000-E	867	WOVEN WIRE FENCE RESET	420 LF		
0094	3628000000-E	876	RIP RAP, CLASS I	105 TON		
0095	3649000000-E	876	RIP RAP, CLASS B	17 TON		
0096	3656000000-E	876	GEOTEXTILE FOR DRAINAGE	485 SY		
0097	4072000000-E	903	SUPPORTS, 3-LB STEEL U-CHANNEL	656 LF		
0098	4096000000-N	904	SIGN ERECTION, TYPE D	3 EA		
0099	4102000000-N	904	SIGN ERECTION, TYPE E	25 EA		
0100	4108000000-N	904	SIGN ERECTION, TYPE F	8 EA		
0101	4155000000-N	907	DISPOSAL OF SIGN SYSTEM, U-CHANNEL	33 EA		

County: ROCKINGHAM

Line #	Item Number	Sec #	Description	Quantity	Unit Cost	Amount
0102	4158000000-N	907	DISPOSAL OF SIGN SYSTEM, WOOD	1 EA		
0103	4400000000-E	1110	WORK ZONE SIGNS (STATIONARY)	857 SF		
0104	4405000000-E	1110	WORK ZONE SIGNS (PORTABLE)	908 SF		
0105	4410000000-E	1110	WORK ZONE SIGNS (BARRICADE MOUNTED)	175 SF		
0106	4415000000-N	1115	FLASHING ARROW BOARD	4 EA		
0107	4420000000-N	1120	PORTABLE CHANGEABLE MESSAGE SIGN	4 EA		
0108	4430000000-N	1130	DRUMS	224 EA		
0109	4434000000-N	1140	SEQUENTIAL FLASHING WARNING LIGHTS	24 EA		
0110	4445000000-E	1145	BARRICADES (TYPE III)	272 LF		
0111	4455000000-N	1150	FLAGGER	180 DAY		
0112	4465000000-N	1160	TEMPORARY CRASH CUSHIONS	3 EA		
0113	4470000000-N	1160	REMOVE & RESET TEMPORARY CRASH CUSHION	3 EA		
0114	4480000000-N	1165	TMA	2 EA		
0115	4485000000-E	1170	PORTABLE CONCRETE BARRIER	3,702 LF		
0116	4500000000-E	1170	REMOVE AND RESET PORTABLE CONCRETE BARRIER	600 LF		
0117	4810000000-E	1205	PAINT PAVEMENT MARKING LINES (4")	3,700 LF		
0118	4815000000-E	1205	PAINT PAVEMENT MARKING LINES (6")	15,310 LF		

County: ROCKINGHAM

Line #	Item Number	Sec #	Description	Quantity	Unit Cost	Amount
0119	4820000000-E	1205	PAINT PAVEMENT MARKING LINES (8")	1,944 LF		
0120	4825000000-E	1205	PAINT PAVEMENT MARKING LINES (12")	949 LF		
0121	4835000000-E	1205	PAINT PAVEMENT MARKING LINES (24")	67 LF		
0122	4845000000-N	1205	PAINT PAVEMENT MARKING SYMBOL	6 EA		
0123	4850000000-E	1205	REMOVAL OF PAVEMENT MARKING LINES (4")	9,505 LF		
0124	4855000000-E	1205	REMOVAL OF PAVEMENT MARKING LINES (6")	7,655 LF		
0125	4860000000-E	1205	REMOVAL OF PAVEMENT MARKING LINES (8")	400 LF		
0126	4865000000-E	1205	REMOVAL OF PAVEMENT MARKING LINES (12")	200 LF		
0127	4875000000-N	1205	REMOVAL OF PAVEMENT MARKING SYMBOLS & CHARACTERS	3 EA		
0128	4890000000-E	SP	GENERIC PAVEMENT MARKING ITEM YIELD LINE INTEGRATED MULTIPOLYMER PAVEMENT MARKING (24", 90 MILS)	16 LF		
0129	4890000000-E	SP	GENERIC PAVEMENT MARKING ITEM YIELD LINE PAINT PAVEMENT MARKING (24")	123 LF		
0130	4891000000-E	1205	GENERIC PAVEMENT MARKING ITEM INTEGRATED MULTIPOLYMER PAVEMENT MARKING LINES (12", 90 MILS)	298 LF		
0131	4891000000-E	1205	GENERIC PAVEMENT MARKING ITEM INTEGRATED MULTIPOLYMER PAVEMENT MARKING LINES (24", 90 MILS)	17 LF		
0132	4891000000-E	1205	GENERIC PAVEMENT MARKING ITEM INTEGRATED MULTIPOLYMER PAVEMENT MARKING LINES (4", 90 MILS)	9,941 LF		
0133	4891000000-E	1205	GENERIC PAVEMENT MARKING ITEM INTEGRATED MULTIPOLYMER PAVEMENT MARKING LINES (6", 90 MILS)	7,169 LF		

County: ROCKINGHAM

Line #	Item Number	Sec #	Description	Quantity	Unit Cost	Amount
0134	4891000000-E	1205	GENERIC PAVEMENT MARKING ITEM INTEGRATED MULTIPOLYMER PAVEMENT MARKING LINES (8", 90 MILS)	161 LF		
0135	4892000000-N	1205	GENERIC PAVEMENT MARKING ITEM INTEGRATED MULTIPOLYMER PAVEMENT MARKING SYMBOLS (90 MILS)	11 EA		
0136	6000000000-E	1605	TEMPORARY SILT FENCE	4,750 LF		
0137	6006000000-E	1610	STONE FOR EROSION CONTROL, CLASS A	110 TON		
0138	6009000000-E	1610	STONE FOR EROSION CONTROL, CLASS B	570 TON		
0139	6012000000-E	1610	SEDIMENT CONTROL STONE	195 TON		
0140	6015000000-E	1615	TEMPORARY MULCHING	5 ACR		
0141	6018000000-E	1620	SEED FOR TEMPORARY SEEDING	400 LB		
0142	6021000000-E	1620	FERTILIZER FOR TEMPORARY SEEDING	2 TON		
0143	6024000000-E	1622	TEMPORARY SLOPE DRAINS	200 LF		
0144	6029000000-E	SP	SAFETY FENCE	260 LF		
0145	6030000000-E	1630	SILT EXCAVATION	780 CY		
0146	6036000000-E	1631	MATTING FOR EROSION CONTROL	8,500 SY		
0147	6037000000-E	1629	COIR FIBER MAT	100 SY		
0148	6042000000-E	1632	1/4" HARDWARE CLOTH	250 LF		
0149	6045000000-E	SP	*** TEMPORARY PIPE (18")	120 LF		

County: ROCKINGHAM

Line #	Item Number	Sec #	Description	Quantity	Unit Cost	Amount
0150	6071002000-E	1642	FLOCCULANT	140 LB		
0151	6071012000-E	1642	COIR FIBER WATTLE	390 LF		
0152	6084000000-E	1660	SEEDING & MULCHING	6 ACR		
0153	6087000000-E	1660	MOWING	3 ACR		
0154	6090000000-E	1661	SEED FOR REPAIR SEEDING	50 LB		
0155	6093000000-E	1661	FERTILIZER FOR REPAIR SEEDING	0.25 TON		
0156	6096000000-E	1662	SEED FOR SUPPLEMENTAL SEEDING	125 LB		
0157	6108000000-E	1665	FERTILIZER TOPDRESSING	3.75 TON		
0158	6114500000-N	1667	SPECIALIZED HAND MOWING	10 MHR		
0159	6114800000-N	SP	MANUAL LITTER REMOVAL	2 MHR		
0160	6114900000-E	SP	LITTER DISPOSAL	1 TON		
0161	6117000000-N	1675	RESPONSE FOR EROSION CONTROL	13 EA		
0162	6117500000-N	SP	CONCRETE WASHOUT STRUCTURE	1 EA		
0163	6132000000-N	SP	GENERIC EROSION CONTROL ITEM FABRIC INSERT INLET PROTECTION CLEANOUT	141 EA		
0164	6132000000-N	SP	GENERIC EROSION CONTROL ITEM FABRIC INSERT INLET PROTECTION, TYPE 2	47 EA		
0165	6132000000-N	SP	GENERIC EROSION CONTROL ITEM PREFABRICATED CONCRETE WASHOUT	5 EA		

County: ROCKINGHAM

Line #	Item Number	Sec #	Description	Quantity	Unit Cost	Amount
<b>WALL ITEMS</b>						
0166	8801000000-E	SP	MSE RETAINING WALL NO **** (1)	2,870 SF		
0167	8801000000-E	SP	MSE RETAINING WALL NO **** (2)	4,040 SF		
<b>STRUCTURE ITEMS</b>						
0168	8035000000-N	402	REMOVAL OF EXISTING STRUCTURE AT STATION ***** (22+03.27 -L-)	Lump Sum	L.S.	
0169	8065000000-N	SP	ASBESTOS ASSESSMENT	Lump Sum	L.S.	
0170	8105560000-E	411	4'-0" DIA DRILLED PIERS IN SOIL	130.4 LF		
0171	8105660000-E	411	4'-0" DIA DRILLED PIERS NOT IN SOIL	47.9 LF		
0172	8113000000-N	411	SID INSPECTIONS	1 EA		
0173	8115000000-N	411	CSL TESTING	1 EA		
0174	8147000000-E	420	REINFORCED CONCRETE DECK SLAB	14,269 SF		
0175	8161000000-E	420	GROOVING BRIDGE FLOORS	14,044 SF		
0176	8182000000-E	420	CLASS A CONCRETE (BRIDGE)	329.7 CY		
0177	8210000000-N	422	BRIDGE APPROACH SLABS, STATION ***** (22+03.27 -L-)	Lump Sum	L.S.	
0178	8217000000-E	425	REINFORCING STEEL (BRIDGE)	50,085 LB		
0179	8238000000-E	425	SPIRAL COLUMN REINFORCING STEEL (BRIDGE)	6,994 LB		
0180	8278000000-E	430	FIB *** PRESTRESSED CONCRETE GIRDERS (54")	1,607.66 LF		

County: ROCKINGHAM

Line #	Item Number	Sec #	Description	Quantity	Unit Cost	Amount
0181	8328200000-E	450	PILE DRIVING EQUIPMENT SETUP FOR *** STEEL PILES (HP 12 X 53)	22 EA		
0182	8364000000-E	450	HP 12 X 53 STEEL PILES	1,100 LF		
0183	8391000000-N	450	STEEL PILE POINTS	22 EA		
0184	8394000000-N	450	DYNAMIC PILE TESTING	1 EA		
0185	8503000000-E	460	CONCRETE BARRIER RAIL	469.75 LF		
0186	8531000000-E	462	4" SLOPE PROTECTION	54 SY		
0187	8657000000-N	430	ELASTOMERIC BEARINGS	Lump Sum	L.S.	
0188	8860000000-N	SP	GENERIC STRUCTURE ITEM STRIP SEAL EXPANSION JOINTS	Lump Sum	L.S.	
0189	8897000000-N	SP	GENERIC STRUCTURE ITEM CONCRETE MEDALLION PANEL	2 EA		

1014/Jun09/Q302673.81/D730385124000/E189

Total Amount Of Bid For Entire Project :

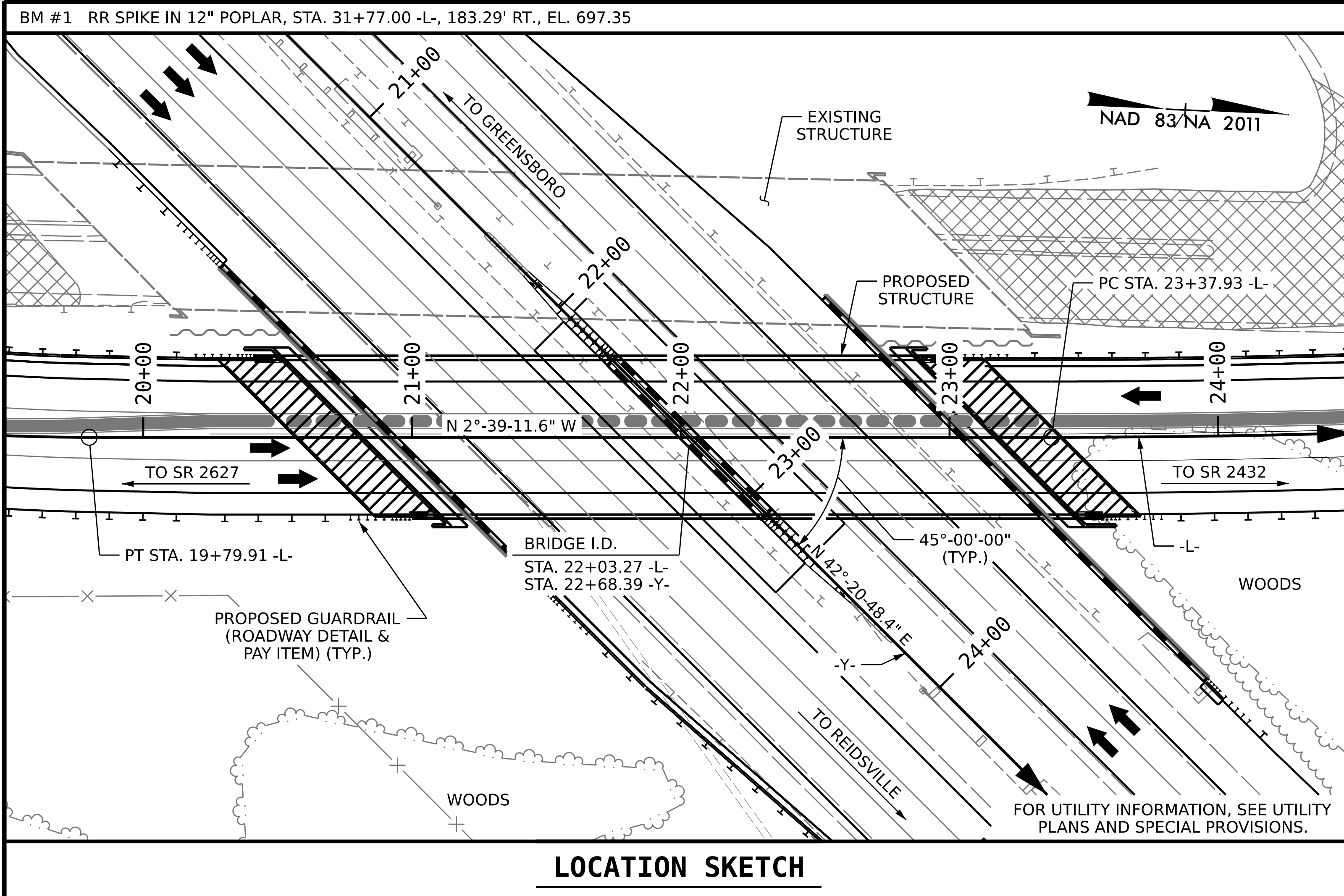

**NOTES:**

- ASSUMED LIVE LOAD - HL-93 OR ALTERNATE LOADING.
- THIS BRIDGE HAS BEEN DESIGNED IN ACCORDANCE WITH THE AASHTO LRFD BRIDGE DESIGN SPECIFICATIONS.
- THIS BRIDGE IS LOCATED IN SEISMIC ZONE 1.
- FOR OTHER DESIGN DATA AND GENERAL NOTES, SEE SHEET SN.
- FOR SUBMITTAL OF WORKING DRAWINGS, SEE SPECIAL PROVISIONS.
- FOR FALSEWORK AND FORMWORK, SEE SPECIAL PROVISIONS.
- FOR CRANE SAFETY, SEE SPECIAL PROVISIONS.
- FOR GROUT FOR STRUCTURES, SEE SPECIAL PROVISIONS.
- THE ELEVATIONS AND CLEARANCES SHOWN ON THE PLANS AT THE POINTS OF MINIMUM VERTICAL CLEARANCE ARE FROM THE BEST INFORMATION AVAILABLE. PRIOR TO BEGINNING BRIDGE CONSTRUCTION, VERIFY THE ELEVATIONS ON THE EXISTING PAVEMENT AND CHECK THE CLEARANCE. REPORT ANY VARIATIONS TO THE ENGINEER. ANY PLAN REVISIONS NECESSARY TO ACHIEVE THE REQUIRED MINIMUM VERTICAL CLEARANCE WILL BE PROVIDED BY THE DEPARTMENT.
- FOR MAINTENANCE AND PROTECTION OF TRAFFIC BENEATH PROPOSED STRUCTURE, SEE SPECIAL PROVISIONS.
- REMOVABLE FORMS MAY BE USED IN LIEU OF METAL STAY-IN-PLACE FORMS IN ACCORDANCE WITH ARTICLE 420-3 OF THE STANDARD SPECIFICATIONS.
- NEEDLE BEAMS WILL NOT BE ALLOWED UNLESS OTHERWISE CALLED FOR ON THE PLANS OR APPROVED BY THE ENGINEER.
- INASMUCH AS THE PAINT SYSTEM ON THE EXISTING STRUCTURAL STEEL CONTAINS LEAD, THE CONTRACTOR'S ATTENTION IS DIRECTED TO ARTICLE 107-1 OF THE STANDARD SPECIFICATIONS. ANY COSTS RESULTING FROM COMPLIANCE WITH APPLICABLE STATE OR FEDERAL REGULATIONS PERTAINING TO HANDLING OF MATERIALS CONTAINING LEAD BASED PAINT SHALL BE INCLUDED IN THE BID PRICE FOR "REMOVAL OF EXISTING STRUCTURE AT STATION 22+03.27 -L."
- THE CLASS AA CONCRETE IN THE BRIDGE DECK SHALL CONTAIN FLY ASH OR GROUND GRANULATED BLAST FURNACE SLAG AT THE SUBSTITUTION RATE SPECIFIED IN ARTICLE 1024-1 AND IN ACCORDANCE WITH ARTICLES 1024-5 AND 1024-6 OF THE STANDARD SPECIFICATIONS. NO PAYMENT WILL BE MADE FOR THIS SUBSTITUTION AS IT IS CONSIDERED INCIDENTAL TO THE COST OF THE REINFORCED CONCRETE DECK SLAB.
- WORK SHALL NOT BE STARTED ON THIS BRIDGE UNTIL ROADWAY SECTION HAS BEEN EXCAVATED.
- FOR LIMITS OF TEMPORARY SHORING FOR MAINTENANCE OF TRAFFIC, SEE TRAFFIC CONTROL PLANS. FOR PAY ITEM FOR TEMPORARY SHORING FOR MAINTENANCE OF TRAFFIC, SEE ROADWAY TEMPORARY WALL DETAILS.

**LOCATION SKETCH**

**TOTAL BILL OF MATERIAL**

	REMOVAL OF EXISTING STRUCTURE	ASBESTOS ASSESSMENT	4'-0" DIA. DRILLED PIER IN SOIL	4'-0" DIA. DRILLED PIER NOT IN SOIL	SID INSPECTION	CSL TESTING	REINFORCED CONCRETE DECK SLAB	GROOVING BRIDGE FLOORS	CLASS A CONCRETE	BRIDGE APPROACH SLABS 22+03.27 -L-	REINFORCING STEEL
	LS	LS	LF	LF	EA	EA	SF	SF	CY	LS	LB
SUPERSTRUCTURE							14,269	14,044			
END BENT 1									105.7		12,589
BENT 1			130.4	47.9	1	1			123.5		24,917
END BENT 2									100.5		12,579
TOTAL	LS	LS	130.4	47.9	1	1	14,269	14,044	329.7	LS	50,085

**TOTAL BILL OF MATERIAL**

	SPIRAL COLUMN REINFORCING STEEL	FIB 54" PRESTRESSED CONCRETE GIRDERS		PILE DRIVING EQUIPMENT SETUP FOR HP 12 X 53 STEEL PILES	HP 12 X 53 STEEL PILES		STEEL PILE POINTS	DYNAMIC PILE TESTING	CONCRETE BARRIER RAIL	4" SLOPE PROTECTION	ELASTOMERIC BEARINGS	STRIP SEALS EXPANSION JOINTS	CONCRETE MEDALLION PANEL
	LB	NO.	LF	EA	NO.	LF	EA	EA	LF	SY	LS	LS	EA
SUPERSTRUCTURE		14	1,607.66						469.75		LS	LS	
END BENT 1				11	11	660	11	1		27			
BENT 1	6,994												2
END BENT 2				11	11	440	11			27			
TOTAL	6,994	14	1,607.66	22	22	1,100	22	1	469.75	54	LS	LS	2

1 CONCRETE MEDALLION PANEL

PROJECT NO. BP7.R001  
ROCKINGHAM COUNTY  
 STATION: 22+03.27 -L-

SHEET 4 OF 5

STATE OF NORTH CAROLINA  
 DEPARTMENT OF TRANSPORTATION  
 RALEIGH

**GENERAL DRAWING**  
 FOR BRIDGE ON US 29 BUS.  
 OVER US 29  
 BETWEEN SR 2627 AND SR 2432

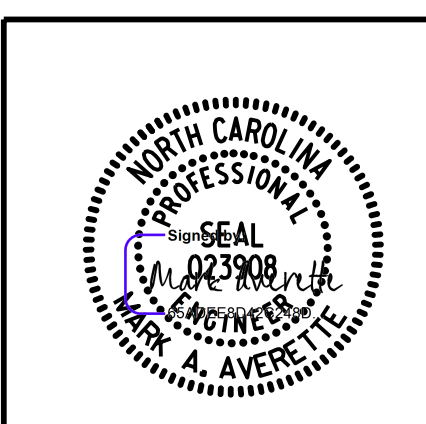

DRAWN BY: T. BANKOVICH DATE: 9-25  
 CHECKED BY: M.A. AVERETTE DATE: 9-25  
 DESIGN ENGINEER OF RECORD: M.A. AVERETTE DATE: 9-25

**DOCUMENT NOT CONSIDERED FINAL  
 UNLESS ALL SIGNATURES COMPLETED**

REVISIONS				SHEET NO.
NO.	BY:	DATE:	NO.	DATE:
1	M.A.A.	6-8-26	3	
2			4	

TOTAL SHEETS: 41

6/9/2026 11:26:02 AM P:\Raleigh\Projects\2023\Div 7 (Mott Macdonald)\BP7.R001 Rockingham 23\Structures\Drawings\Final\BP7.R001\_SMU\_G004\_780023.dgn



6/8/2026 8:06:34 AM P:\Raleigh\Projects\2023\Div 7 (Mott MacDonald)\BP7R001 Rockingham 23\Structures\Drawings\Final\BP7R001\_SMU\_B03\_780023.dgn  
 D:\Users\mcc\Documents\Projects\2023\Div 7 (Mott MacDonald)\BP7R001 Rockingham 23\Structures\Drawings\Final\BP7R001\_SMU\_B03\_780023.dgn

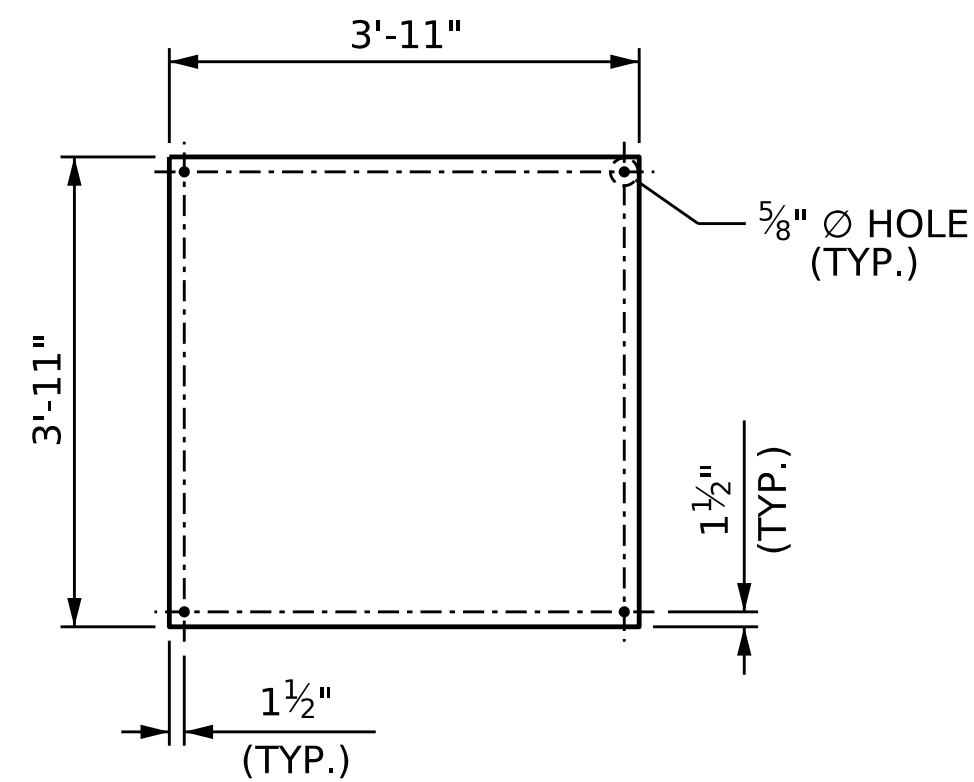
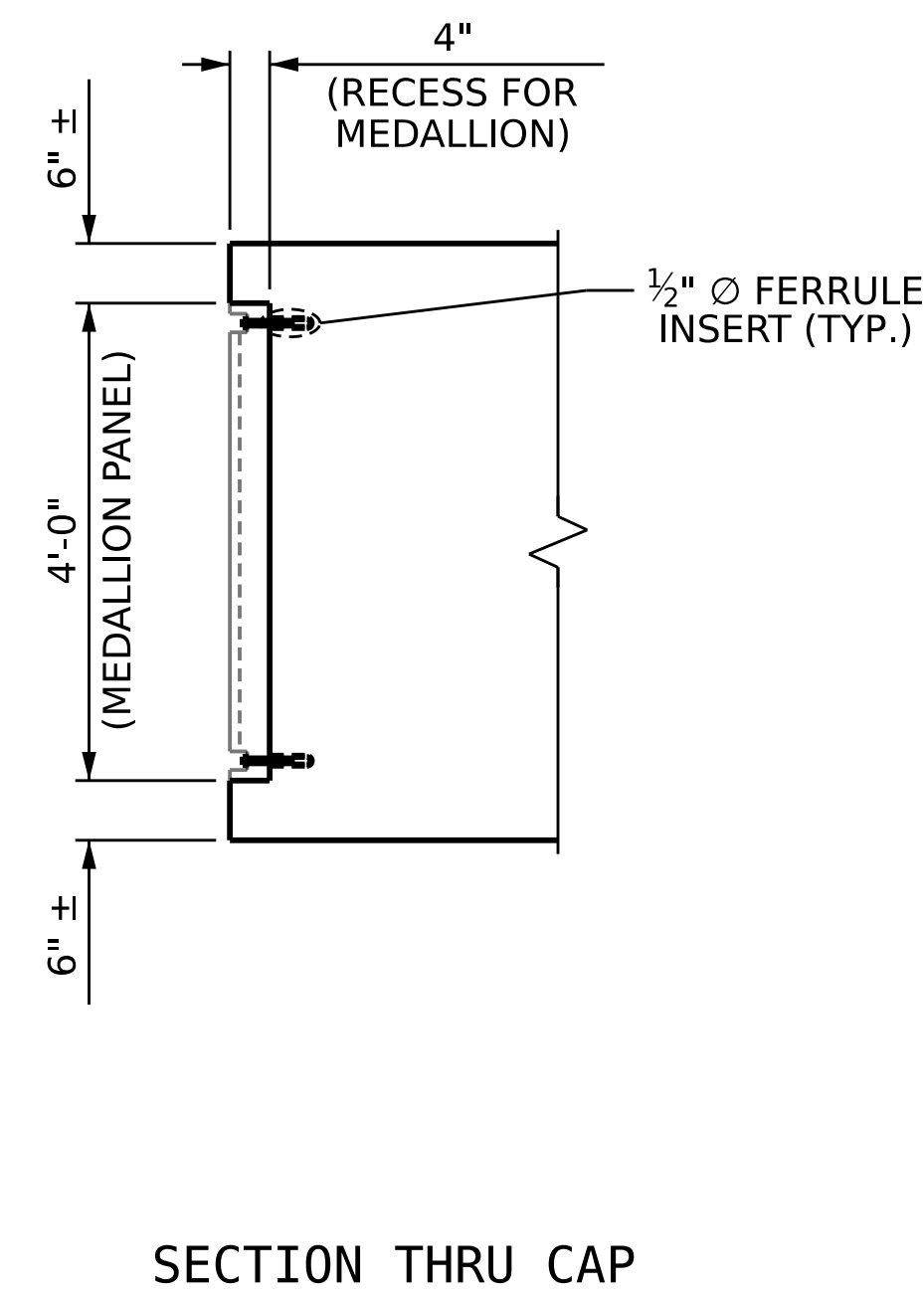
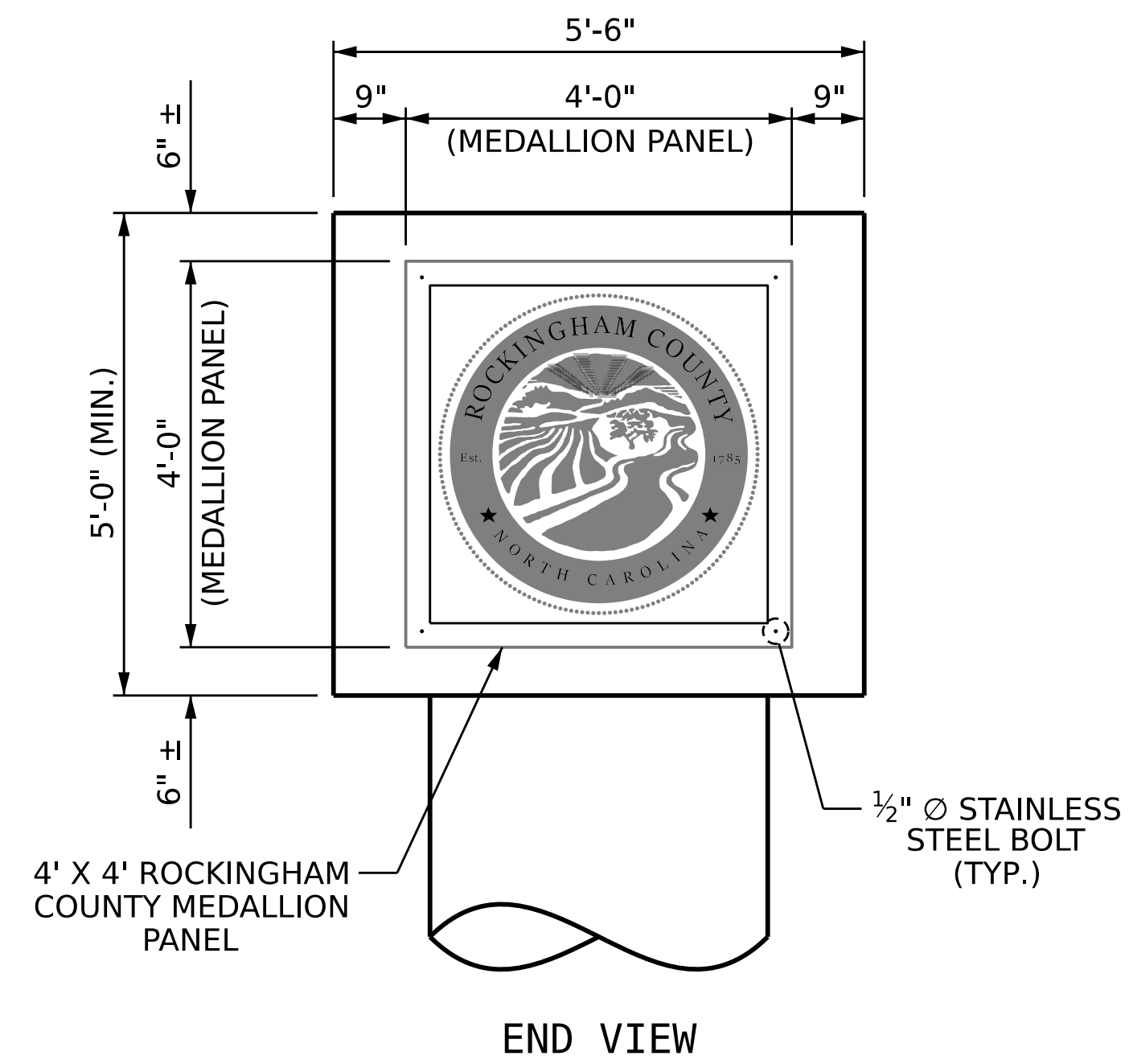

**1/4" PERFORMED BEARING PAD**

**NOTES:**

ADJUST DIMENSIONS AS NECESSARY TO CENTER PANEL ON END OF BENT CAP AND ALIGN PANEL WITHIN RECESS.

USE CLASS "A" CONCRETE WITH PEA GRAVEL AGGREGATE IN THAT DECORATIVE PANELS. IN ADDITION TO THE #3 REINFORCING BARS. CONCRETE TO BE REINFORCED WITH POLYPROPYLENE FIBERS PER THE MANUFACTURERS' RECOMMENDATIONS.

PERFORMED BEARING PAD SHALL COMFORM TO SECTION 1079-1 OF THE STANDARD SPECIFICATIONS. AT THE CONTRACTOR'S OPTION, AN UNREINFORCED PLAIN ELASTOMERIC PAD MAY BE USED.

FERRULES SHALL BE MADE FROM ALLOY 304 STAINLESS STEEL AND SHALL HAVE A MINIMUM LENGTH OF THREADS OF 11#2" FOR 1#2" DIAMETER FERRULES.

BOLTS SHALL MEET THE REQUIREMENTS OF ASTM F593 ALLOY 304 STAINLESS STEEL WITH MINIMUM 75,000 PSI TENSILE STRENGTH, AND WASHERS SHALL MEET THE REQUIREMENTS OF ASTM F844 EXCEPT THEY SHALL BE MADE FROM ALLOY 304 STAINLESS STEEL.

THE CONTRACTOR MAY USE 1#2" DIAMETER ADHESIVELY ANCHORED THREADED ROD IN PLACE OF THE FERRULE ANCHOR INSERTS. FIELD TESTING OF THE ADHESIVE ANCHORS IS NOT REQUIRED.

WHEN ADHESIVELY ANCHORED THREADED RODS ARE USED, RODS SHALL MEET THE REQUIREMENTS OF ASTM A276, ALLOY 304 STAINLESS STEEL WITH MINIMUM 75,000 PSI TENSILE STRENGTH, NUTS SHALL MEET THE REQUIREMENTS OF ASTM F594 ALLOY 304 STAINLESS STEEL AND WASHERS SHALL MEET THE REQUIREMENTS OF ASTM F844 EXCEPT THEY SHALL BE MADE FROM ALLOY 304 STAINLESS STEEL.

THE COST OF THE ATTACHMENT ANCHORS WITH BOLTS AND WASHER IN PLACE SHALL BE INCLUDED IN THE PRICE BID PER EACH FOR THE CONCRETE MEDALLION PANEL.

**ATTACHMENT OF MEDALLION TO BENT**

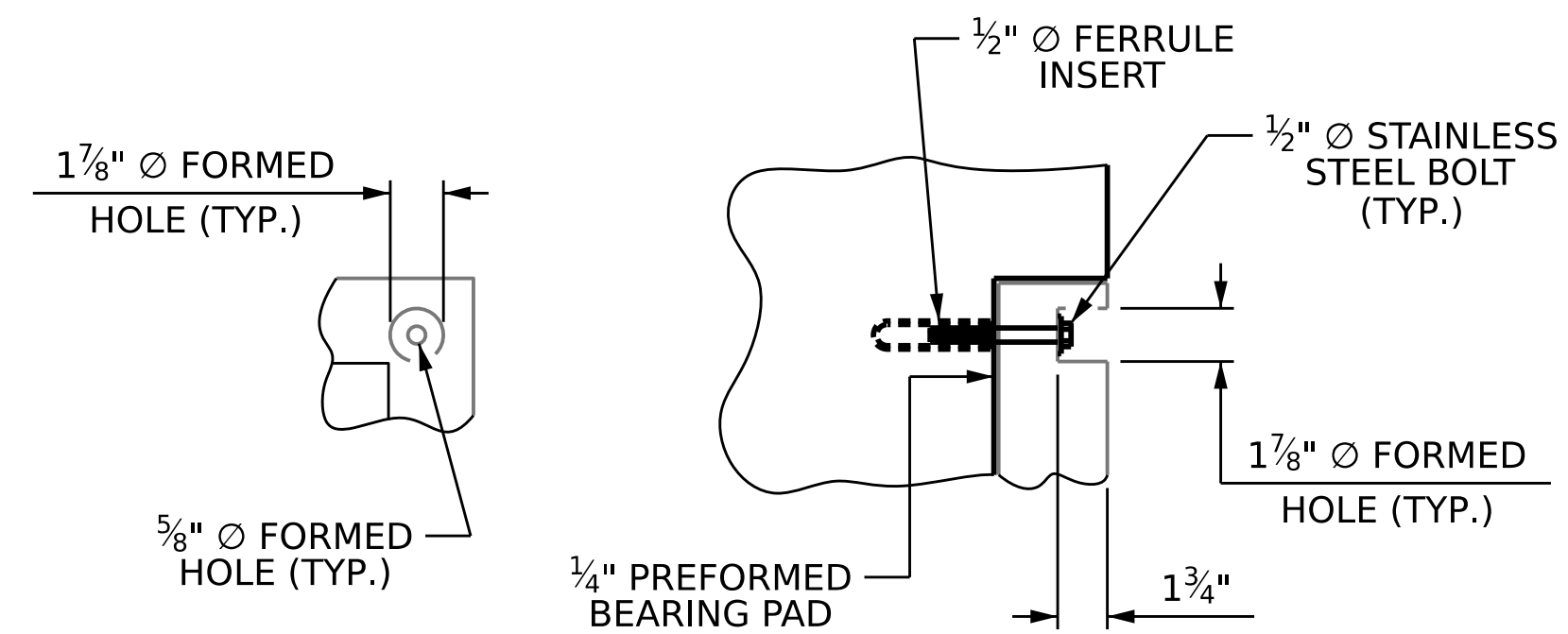
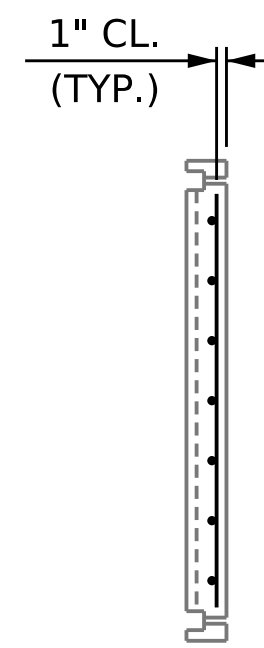
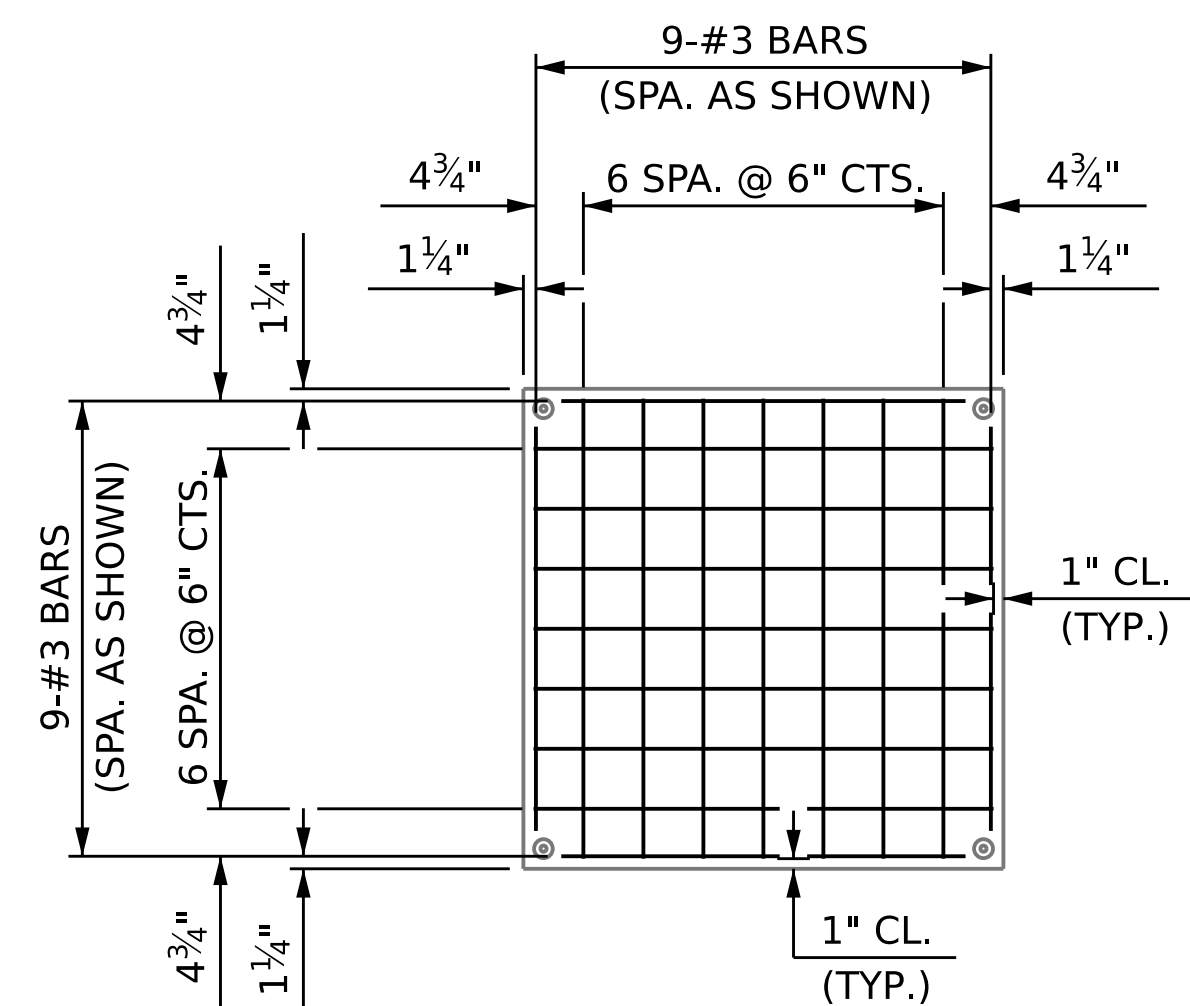
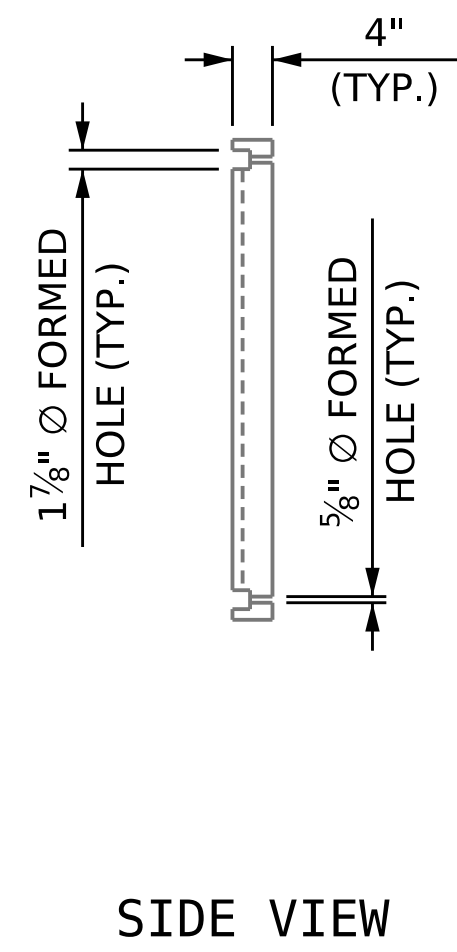
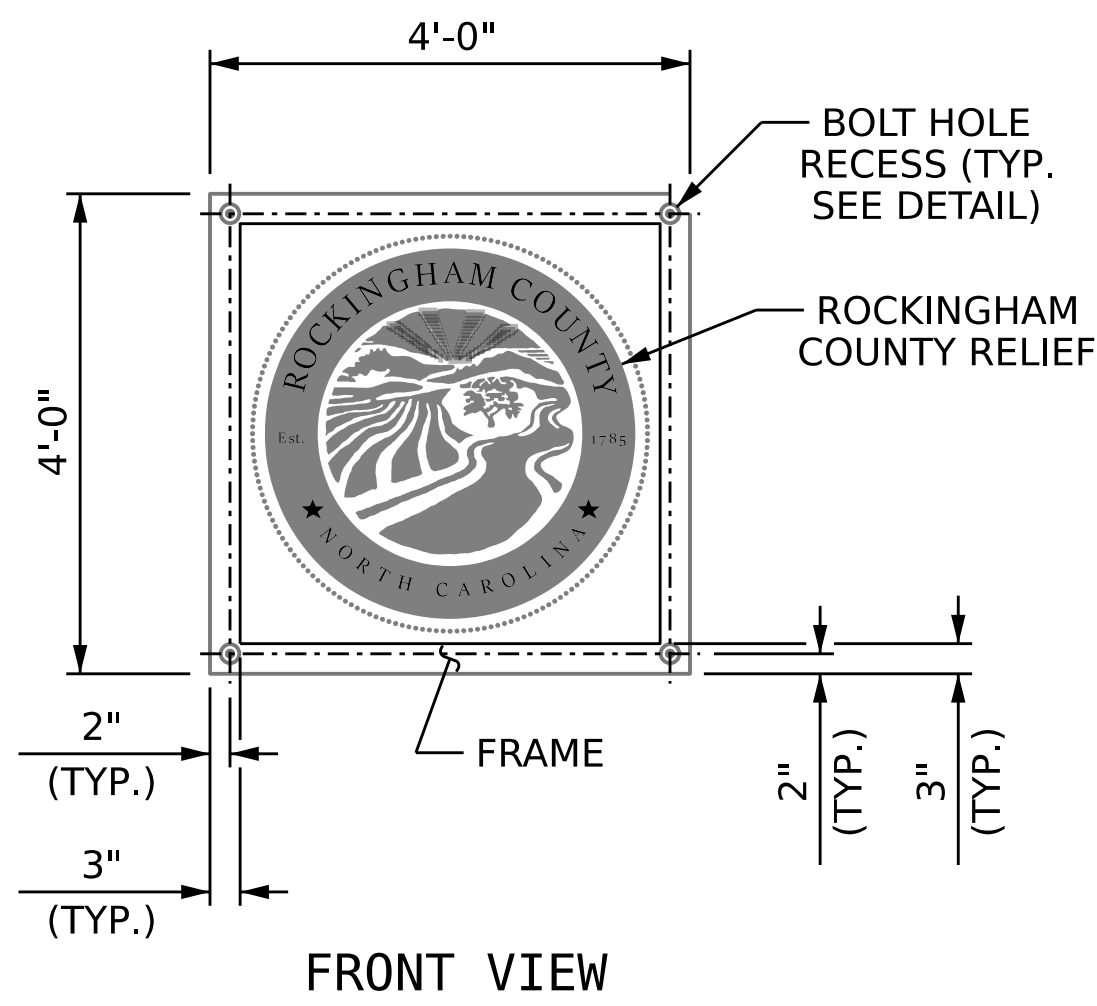

**ROCKINGHAM COUNTY MEDALLION PANEL DETAILS**

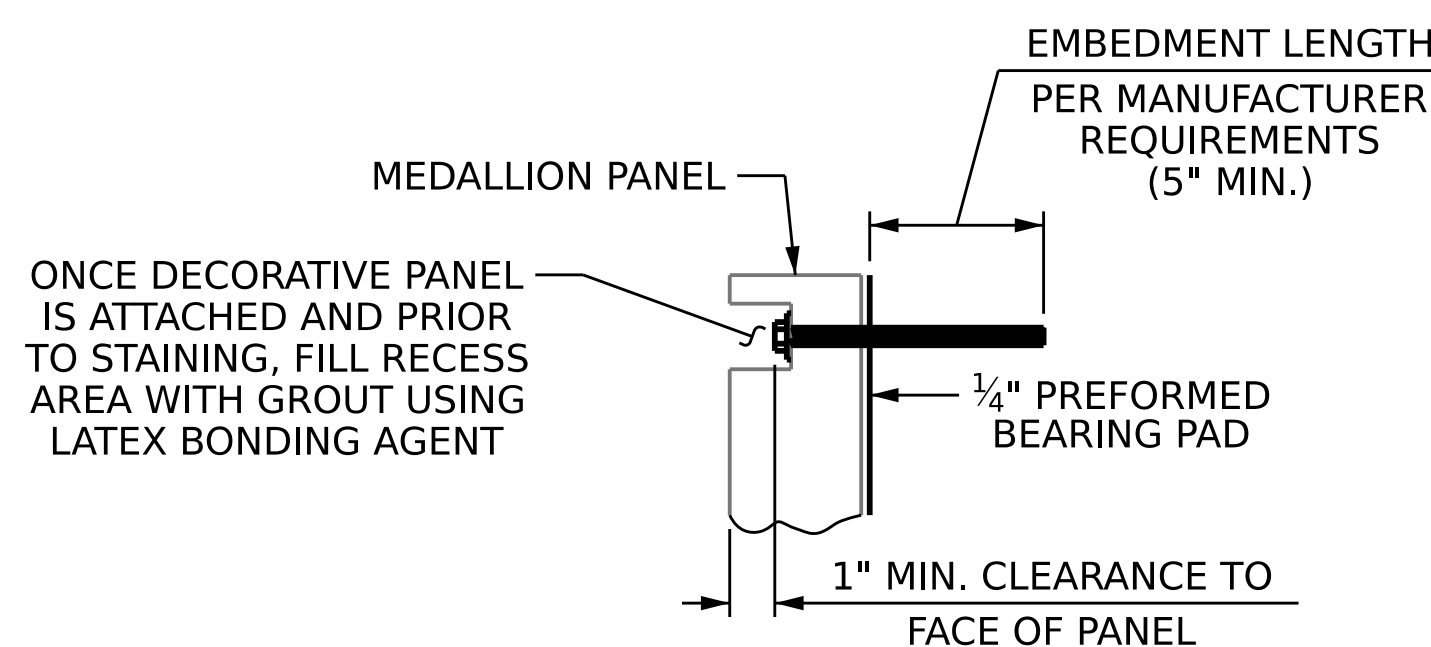

**OPTIONAL ATTACHMENT DETAIL**

(SEE NOTES)

PROJECT NO. BP7.R001  
ROCKINGHAM COUNTY  
 STATION: 22+03.27 -L-

STATE OF NORTH CAROLINA  
 DEPARTMENT OF TRANSPORTATION  
 RALEIGH

**DECORATIVE PANEL  
 DETAILS**



5640 Dillard Drive, Suite 200  
 Cary, NC 27518

LICENSURE NO. C-5315

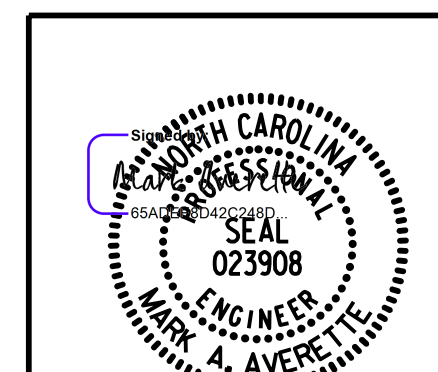

6/8/2026 | 5:10 AM PDT

DRAWN BY :	T. BANKOVICH	DATE :	9-25
CHECKED BY :	M.A. AVERETTE	DATE :	9-25
DESIGN ENGINEER OF RECORD :	M.A. AVERETTE	DATE :	9-25

REVISIONS						SHEET NO. S-34A
NO.	BY:	DATE:	NO.	BY:	DATE:	
1			3			TOTAL SHEETS 41
2			4			

**DOCUMENT NOT CONSIDERED FINAL  
 UNLESS ALL SIGNATURES COMPLETED**